

Opening Height= **H**  
 Height of Holes= **73mm + H**  
 Height of Moving Glass Panel (A) = **52mm + H**

Guide Rail Hole-to-Hole distance = 535mm (21 inches)

**Important Notes:**

- 1.The Opening must be 100% levelled and straight

Height of Holes= **H+73mm**  
 (For Wall Mount Applications)

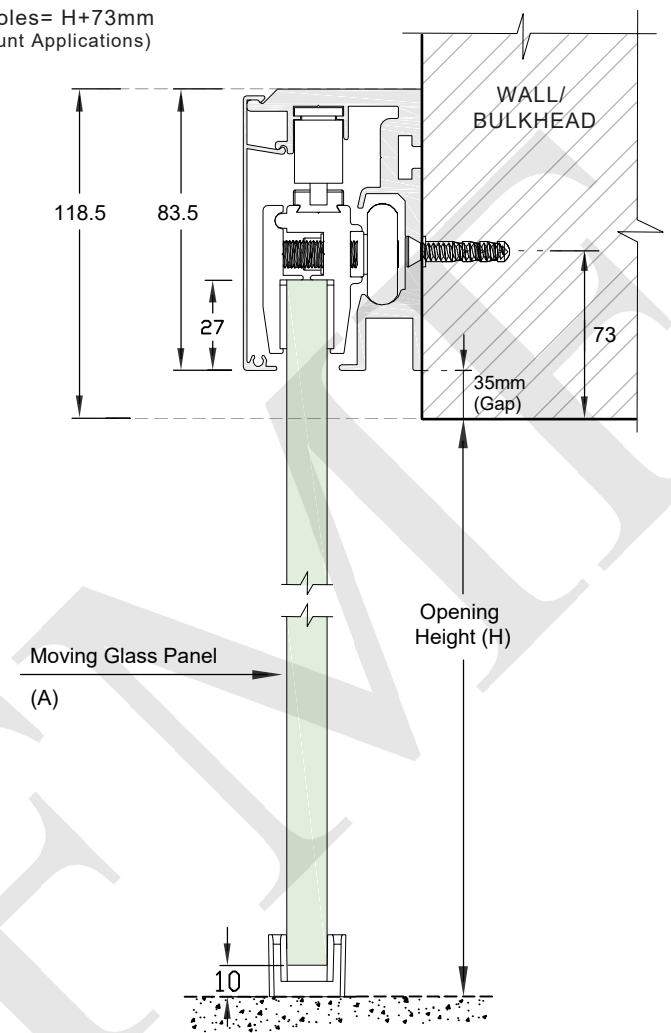

Height of the moving glass Panel (A) =  $H - 10 + 27 + 35 = H + 52mm$

**WALL MOUNT APPLICATION - TYPE 1**

<b>NOTES:</b>  - PROPRIETARY AND CONFIDENTIAL -THE INFORMATION CONTAINED IN THIS DRAWING IS THE SOLE PROPERTY OF FMF GLASS HARDWARE. ANY REPRODUCTION IN PART OR AS A WHOLE WITHOUT THE WRITTEN PERMISSION OF FMF GLASS HARDWARE IS PROHIBITED.	PRODUCT NAME: <b>HSK Series Sliding Door System</b>		PRODUCT MODEL NUMBER: <b>HSK-02W</b>	
	DWG NO. <b>HSK-02W_1</b>	UNIT: <b>MM</b>	DWG SIZE/SCALE <b>A4/NTS</b>	REV. <b>1</b>
	DATE: <b>12.23</b>	DRAWN BY: <b>FMF</b>	<b>FMF GLASS HARDWARE</b>	SHEET 1 OF 1

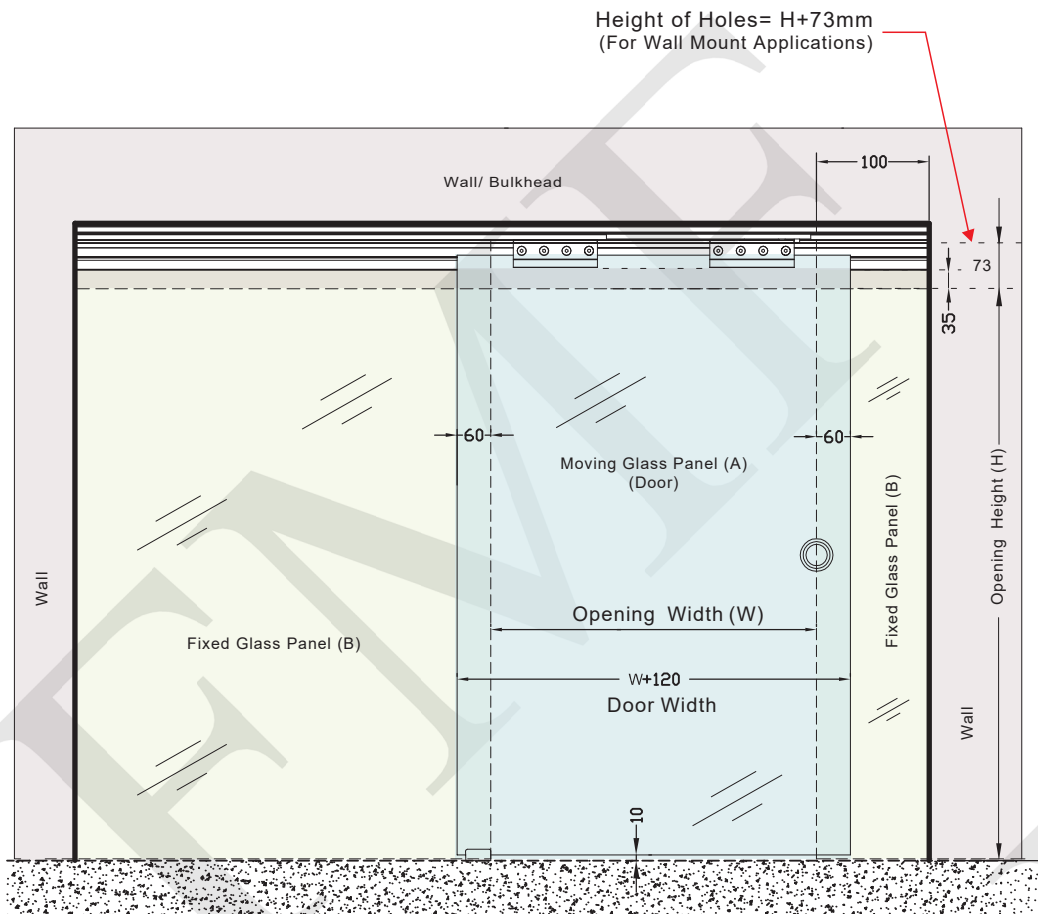

Opening Height= H

Height of Holes= 73mm + H

Height of Moving Glass Panel (A) = 52mm + H

Height of Fixed Glass Panel (B) = 47.5mm + H

Guide Rail Side Mount Hole-to-Hole distance = 535mm (21 inches)

#### Important Notes:

1. The Opening must be 100% levelled and straight

#### NOTES:

- PROPRIETARY AND CONFIDENTIAL  
- THE INFORMATION CONTAINED IN THIS  
DRAWING IS THE SOLE PROPERTY OF FMF  
GLASS HARDWARE. ANY REPRODUCTION  
IN PART OR AS A WHOLE WITHOUT THE  
WRITTEN PERMISSION OF FMF GLASS  
HARDWARE IS PROHIBITED.

#### PRODUCT NAME:

HSK Series Sliding Door System

#### PRODUCT MODEL NUMBER:

HSK-02W

#### DWG NO.

HSK-02W\_2

#### UNIT:

MM

#### DATE:

12.23

#### DRAWN BY:

FMF

#### DWG SIZE/SCALE

A4/NTS

**FMF GLASS  
HARDWARE**

#### REV.

1

SHEET 1 OF 1

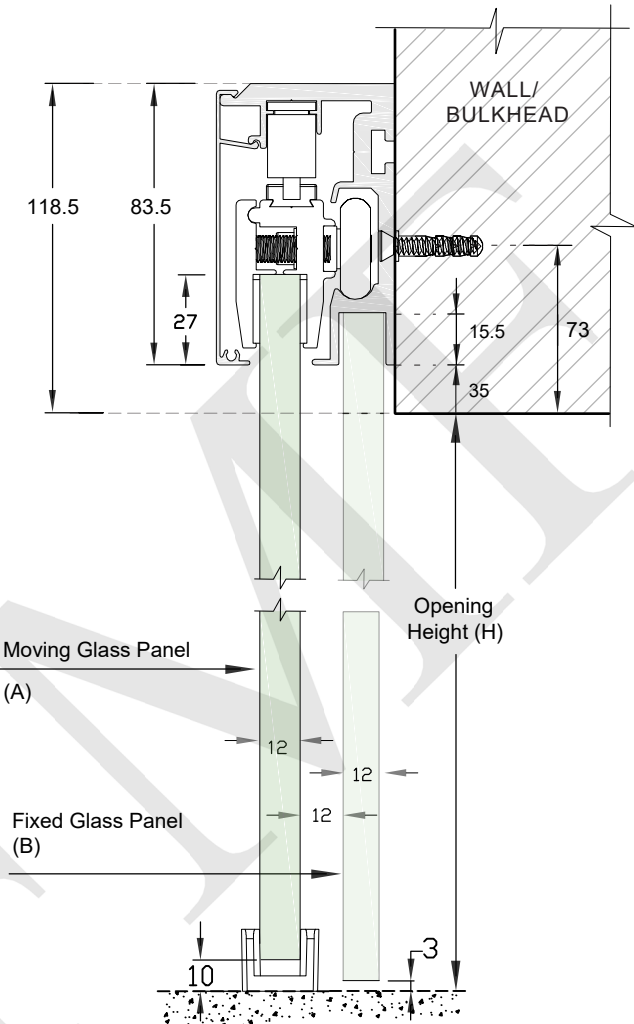

Height of Panel A =  $H + 35 + 27 - 10 = H + 52\text{mm}$

Height of Panel B =  $H + 35 + 15.5 - 3 = H + 47.5\text{mm}$

#### WALL MOUNT APPLICATION- TYPE 2

12 11 10 9 8 7 6 5 4 3 2 1

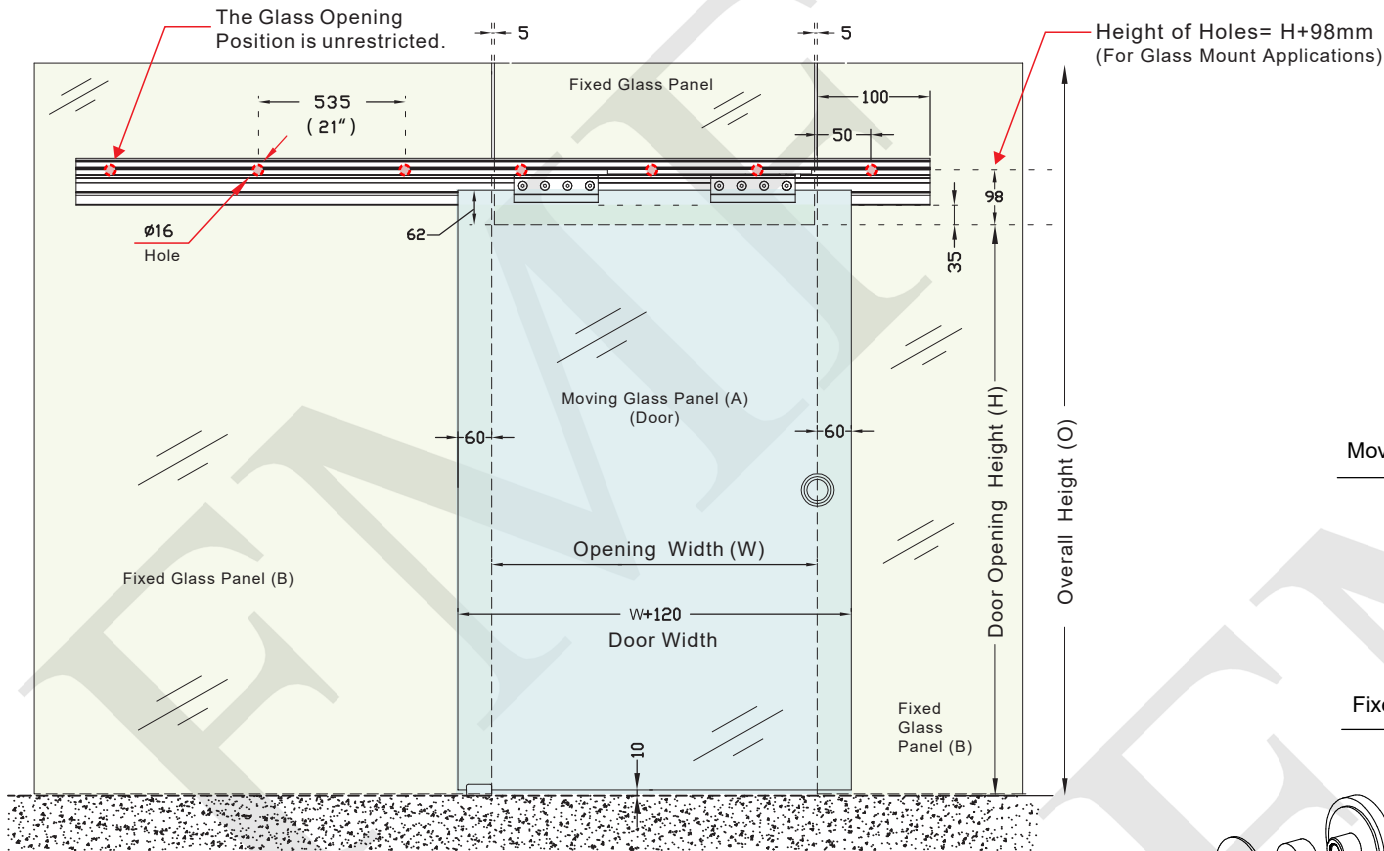

Door Opening Height=  $H$   
Height of Holes=  $H+98\text{mm}$ ; Diameter of Holes: 16mm  
Height of Moving Glass Panel (A) =  $H+52\text{mm}$

Guide Rail Hole-to-Hole distance = 535mm (21 inches)

#### Important Notes:

- 1.The Opening must be 100% levelled and straight
2. For Glass Mount Applications, 6pcs of Glass Connector (HSK-01) Required per each 120" Rail

#### NOTES:

- PROPRIETARY AND CONFIDENTIAL  
-THE INFORMATION CONTAINED IN THIS DRAWING IS THE SOLE PROPERTY OF FMF GLASS HARDWARE. ANY REPRODUCTION IN PART OR AS A WHOLE WITHOUT THE WRITTEN PERMISSION OF FMF GLASS HARDWARE IS PROHIBITED.

#### PRODUCT NAME:

HSK Series Sliding Door System

#### PRODUCT MODEL NUMBER:

HSK-02W

#### DWG NO.

HSK-02W\_3

#### UNIT:

MM

#### DATE:

12.23

#### DRAWN BY:

FMF

#### DWG SIZE/SCALE

A4/NTS

**FMF GLASS  
HARDWARE**

#### REV.

1

SHEET 1 OF 1

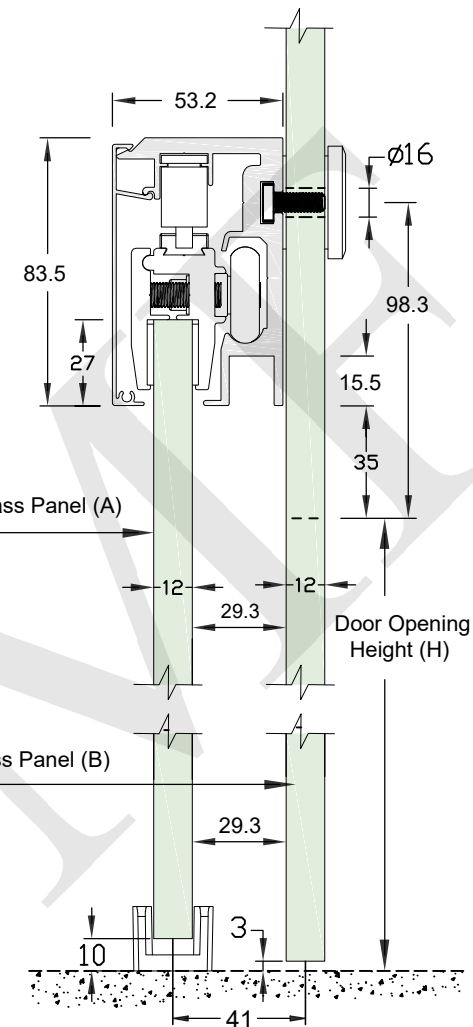

The height of the moving glass=  $H-10+62 = H+52\text{mm}$

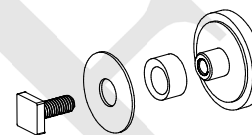

#### GLASS MOUNT APPLICATION

12 11 10 9 8 7 6 5 4 3 2 1

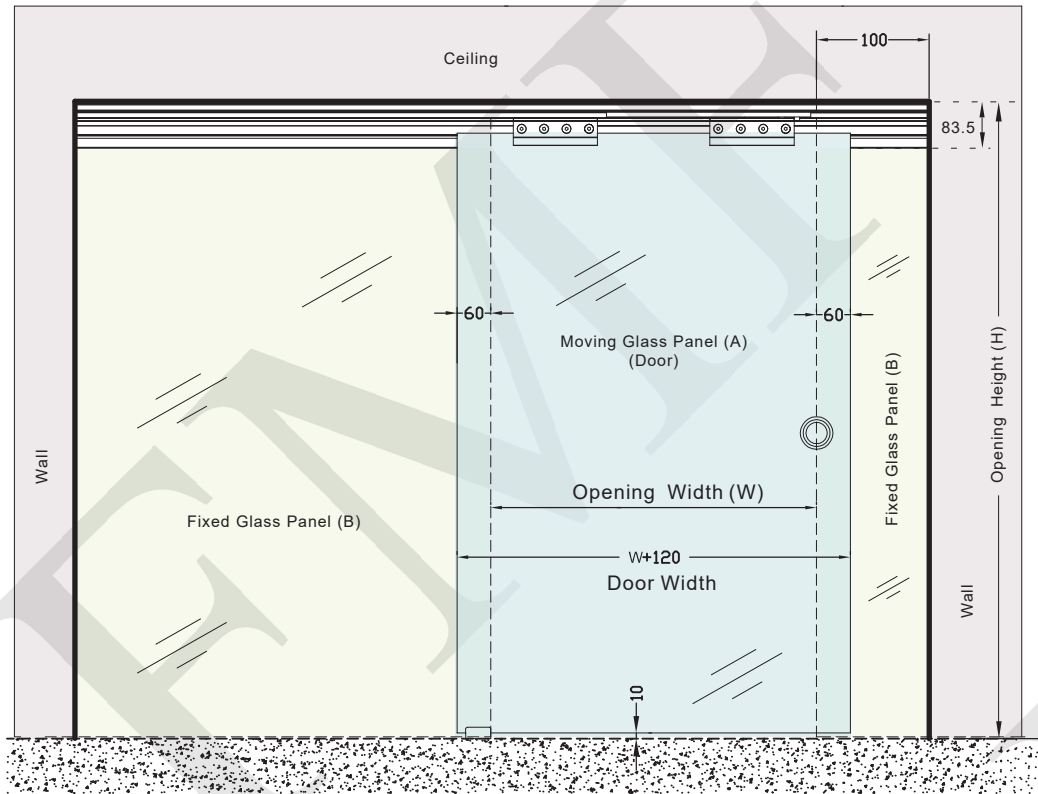

Guide Rail Top Mount Hole-to-Hole distance = 535mm (21 inches)  
Deduction for Moving Glass Panel (A) = **66.5mm** from Opening Height  
Deduction for Fixed Glass Panel (B) = **71mm** from Opening Height

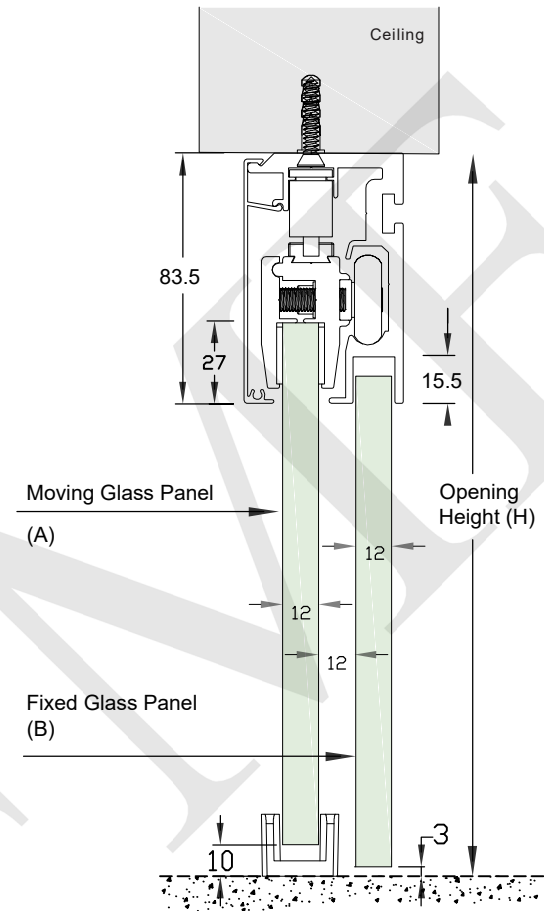

**Height of Panel A** =  $H - 83.5 + 27 - 10 = H - 66.5\text{mm}$   
**Height of Panel B** =  $H - 83.5 + 15.5 - 3 = H - 71\text{mm}$

#### CEILING MOUNT APPLICATION

#### Important Notes:

1. The Opening must be 100% level and plumb
2. For Glass Mount Applications, 6pcs of Glass Connector (HSK-01) Required per each 120" Rail

#### NOTES:

- PROPRIETARY AND CONFIDENTIAL  
-THE INFORMATION CONTAINED IN THIS DRAWING IS THE SOLE PROPERTY OF FMF GLASS HARDWARE. ANY REPRODUCTION IN PART OR AS A WHOLE WITHOUT THE WRITTEN PERMISSION OF FMF GLASS HARDWARE IS PROHIBITED.

#### PRODUCT NAME:

HSK Series Sliding Door System

#### PRODUCT MODEL NUMBER:

HSK-02W

#### DWG NO.

HSK-02W\_4

#### UNIT:

MM

#### DATE:

12.23

#### DRAWN BY:

FMF

#### DWG SIZE/SCALE

A4/NTS

**FMF GLASS  
HARDWARE**

#### REV.

1

SHEET 1 OF 1

